

These particulars are believed to be accurate but they are not guaranteed and do not form a contract. Neither Jordan Fishwick nor the vendor or lessor accept any responsibility in respect of these particulars, which are not intended to be statements or representations of fact and any intending purchaser or lessee must satisfy himself by inspection or otherwise as to the correctness of each of the statements contained in these particulars. Any floorplans on this brochure are for illustrative purposes only and are not necessarily to scale.

Whilst every attempt has been made to ensure the accuracy of the floorplan contained herein, measurements of doors, windows, rooms and other items are approximate and no responsibility is taken for any omission or mis-statement. This plan is for illustrative purposes only and should be used as such for any prospective purchaser. The services, systems and appliances shown here and omitted and no guarantee as to their operability or efficiency can be given.

Made with Mapbox (2020)

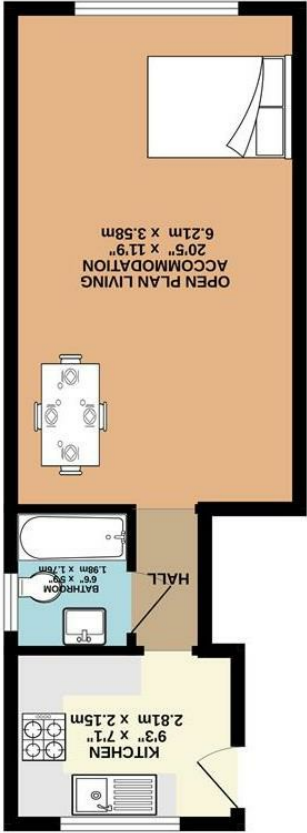

GROUND FLOOR
350 sq.ft. (32.5 sq.m.) approx.





15A Kinder Road, Hayfield, High Peak, SK22 2HJ

£150,000



The Property

****Calling all First Time Buyers**** A delightful first-floor studio apartment set in the heart of Hayfield Village. One of only seven in a Grade II listed Weavers Cottage. Tastefully presented throughout, the property enjoys open views and access to a communal garden. The accommodation briefly comprises a communal entrance hall with stairs to the first floor, a private front door leading to a fitted kitchen, inner hallway, recently fitted bathroom, and an open-plan living, dining and sleeping area with hardwood flooring. Original beams add character, while stunning forward views overlook Hayfield village and the surrounding open countryside. Immaculately presented and ready to move into, this is a perfect low-maintenance and affordable home, beautifully positioned in an idyllic setting.



- Immaculate First Floor Studio Flat
- Idyllic Location in the Heart of Hayfield Village
- Recently Fitted Modern Bathroom
- Well Equipped Kitchen
- Communal Rear Garden
- Open Plan Living Dining Bedroom Cleverly Separated by Full Height Shelving
- Original Beamed Ceiling and Hardwood Flooring
- Forward Views Over Hayfield Village and Countryside Beyond

Postcode - SK22 2HJ
EPC Rating -
Local Authority - High Peak
Council Tax - A

